

Eliza's Star

designed by Marsha Evans Moore
featuring Eliza Star fabric collection by Williamsburg

SIZE: 70-1/2" x 70-1/2"



THIS IS A DIGITAL REPRESENTATION OF THE QUILT TOP, FABRIC MAY VARY.



Eliza's Star

Please note: Read the entire pattern before you begin. The diamond template is found on page 5.

| KEY | FABRIC | SKU | YD | CUTTING INSTRUCTIONS |
|-----|--------|----------|-------|--|
| A | | 52403M-1 | 7/8 | (1) 17-1/2" x WOF; subcut (2) 17-1/2" squares; cut each square in half once to make (4) triangles. (1) 6-1/2" x WOF strip; subcut (4) 6-1/2" squares. |
| B | | 52403M-3 | 1-7/8 | (7) 7-1/2" x WOF strips; sew ends together. Subcut (2) 7-1/2" x 56-1/2" borders and (2) 7-1/2" x 70-1/2". (1) 3" x WOF strip; subcut (8) diamonds. |
| C | | 52404M-1 | 1 | (3) 4-1/2" x WOF strips; subcut (24) 4-1/2" squares. Cut each square in half once to make (48) triangles. (1) 4" x WOF strip; subcut (8) 4" squares. (3) 3-1/2" x WOF strips; subcut (32) 3-1/2" squares. Cut each square in half once to make (64) triangles. |
| D | | 52404M-3 | 5/8 | (4) 2" x WOF strips; subcut (4) 2" x 37-1/2" borders. (2) 3" x WOF strip; subcut (12) diamonds. |
| E | | 52405M-2 | 5/8 | (5) 3" x WOF strips; subcut (32) diamonds. |
| F | | 52406M-1 | 3/8 | (2) 8" squares; cut each square in half diagonally to make (4) triangles. |
| G | | 52406M-3 | 5/8 | (6) 3" x WOF strips; subcut (44) diamonds. |
| H | | 52406M-4 | 7/8 | (4) 2-7/8" x WOF strips; subcut (2) 2-7/8" squares and (4) 2-1/2" squares. Cut 2-7/8" squares in half diagonally once to make (4) triangles. FOR BINDING: (8) 2-1/4" x WOF strips; trim ends diagonally. Sew ends together. |

Project Disclaimer: Every effort has been made to ensure that all projects are error free. All the information is presented in good faith, however, no warranty can be given nor results guaranteed. Therefore, we assume no responsibility nor damages that may occur when referring to this pattern. When errors are brought to our attention, we make every effort to correct and post a revision as soon as possible. We suggest you test the pattern prior to making the project. Test templates first, before cutting all the pieces.



Eliza's Star

| KEY | FABRIC | SKU | YD | CUTTING INSTRUCTIONS |
|-----|--------|----------|-------|---|
| I | | 52408M-2 | 3/4 | (8) 2-1/2" x WOF strips; sew ends together. Subcut (4) 2-1/2" x 52-1/2" borders and (4) 2-1/2" x 24-1/2". |
| | | Backing | 4-3/4 | Batting 80" x 80" |

ADDITIONAL MATERIALS

Thread to match fabrics

Basic sewing supplies

Optional: Template plastic

Sewing machine

Rotary cutter, ruler and mat

BLOCKS

Note: Measure and mark the end of the seamline at the point and side corner on the wrong side, if necessary, to ensure accuracy when sewing the diamonds together.

1. Sew (2) **B** diamonds together beginning at the center point and ending at the side corner of the seamline to make a diamond pair. Make 4.

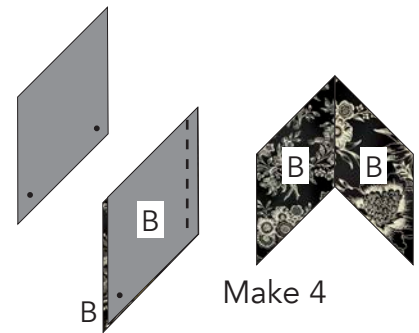

2. Sew (1) **B** diamond of the diamond pair to (1) **C** 4" square beginning and ending at the corners of the seamline.

3. Sew second **B** diamond to adjacent side of **C** 4" square beginning and ending at the corners of the seamline diamond pair units. Make 4.

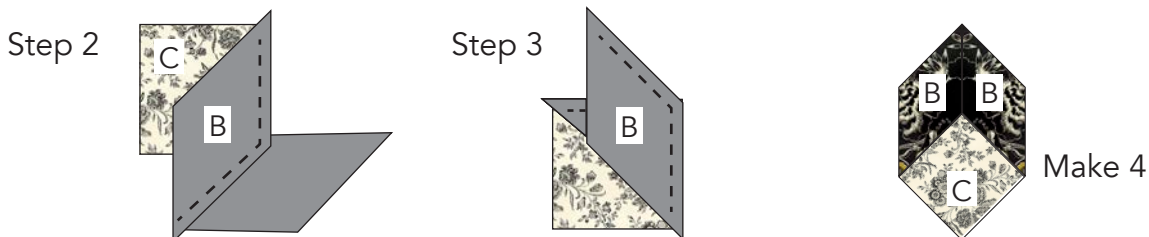

4. Sew (2) **B** diamond pair units together along the side of the diamond ending at the corners of the seamline. Make 2.

5. Following steps 2-3, sew sides of diamonds to (1) **C** 4" square to make half star units. Make 2.

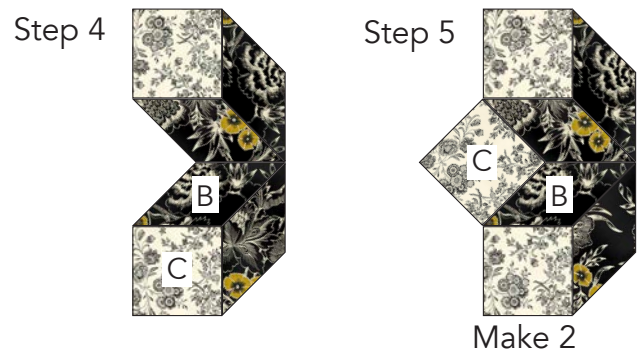



Eliza's Star

6. Sew (2) half star units together along the sides of the diamonds beginning and ending at the corners of the seamline.

7. Following steps 2-3, sew sides of diamonds to (2) **C** 4" squares to make star center. Make 1.

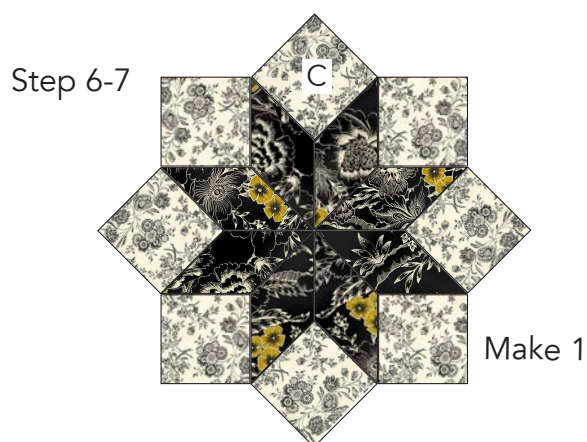

8. Sew (1) **D** diamond to (1) **G** diamond beginning and ending at the corners of the seamline. Sew (1) **G** diamond to **D** side of diamond pair to make **GDG** 3-diamond unit.

9. Sew (2) **C** 4-1/2" triangles to 3-diamond unit using the technique in steps 2-3. Do not end stitching at marked outer point of diamonds; sew to edge of fabric. Make 4.

10. Following steps 8-9 make 3-diamond units alternating (2) **D** diamonds and (1) **G** diamond to make a **DGD** 3-diamond unit. Add C triangles. Make 4.

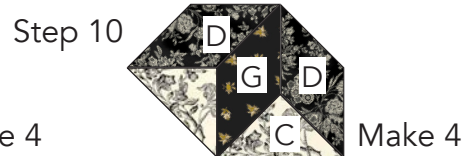
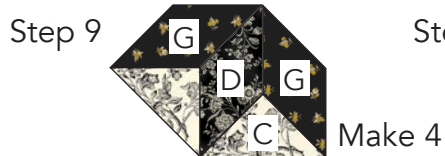

11. Sew (4) **GDG** 3-diamond units alternating with (4) **DGD** 3-diamond units to the **C** squares beginning and ending at the corners of the seamline.

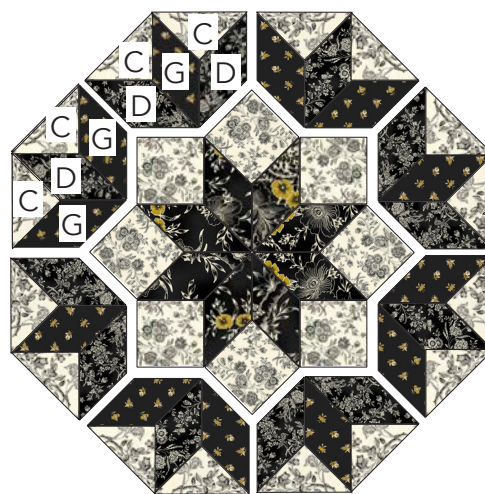



Eliza's Star

12. Sew the 3-diamond units together beginning at the corner of the seamline and ending at the outer edge of the fabric to make an octagon. Make 1.

13. Sew (4) **F** 8" triangles to octagon to make the Center Block. Center Block should measure 24-1/2" square including seam allowance. Make 1.

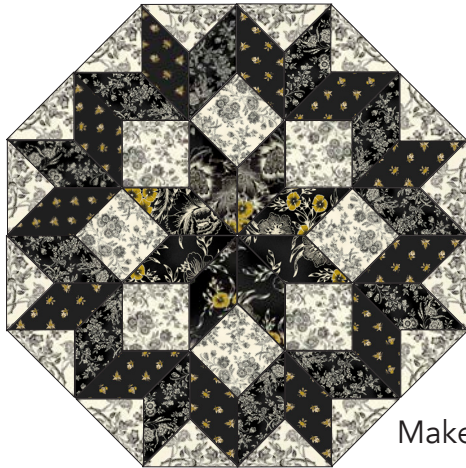

Make 1

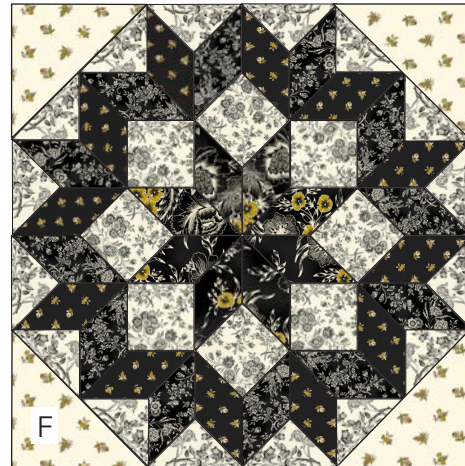

Make 1

14. Sew (1) **I** 2-1/2" x 24-1/2" strip to the sides of the Center Block. Sew (2) **H** 2-7/8" triangles to ends of (2) **I** 2-1/2" x 24-1/2" strips. Sew to remaining sides of the Center Block.

15. Sew (1) **A** 17-1/2" triangles to sides of **I** 2-1/2" x 24-1/2" strips to make quilt center. Quilt center should measure approximately 37-1/2" square including seam allowance.



Make 1

PATCHWORK BORDER

16. Following step 1 sew (1) **E** diamond to one **G** diamond.

17. Following steps 2-3 substituting (1) **C** 4-1/2" triangle for the **C** 4" square.

18. Sew (2) **C** 3-1/2" triangles to the diamonds to make a diamond border unit. Diamond border units should measure 6-1/2" x 5-1/2" including seam allowance. Make 32.

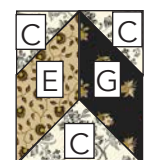

Make 32



Eliza's Star

19. Sew (8) diamond border units together so patchwork border measures 6-1/2" x 40-1/2" including seam allowance. Make 4.



Make 4

20. Sew (2) **A** 6-1/2" squares to the ends of (2) patchwork borders. Make 2.



Make 2

BORDERS

21. Following the Quilt Layout on page 6, sew (1) **D** 2" x 37-1/2" border to sides of quilt center. Sew (2) **H** 2" squares to (2) **D** 2" x 37-1/2" borders. Sew to top and bottom of quilt center.

22. Sew (1) patchwork border without squares to sides of quilt. Note orientation of diamonds. Sew patchwork borders with squares to top and bottom of quilt matching seams.

23. Sew (1) **I** 2-1/2" x 52-1/2" borders to sides of quilt. Sew (2) **H** 2-1/2" squares to (2) **I** 2-1/2" x 52-1/2" borders. Sew to top and bottom of quilt.

24. Sew (1) **B** (2) 7-1/2" x 56-1/2" borders to sides of quilt. Sew (2) **B** 7-1/2" x 70-1/2" borders to top and bottom of quilt.

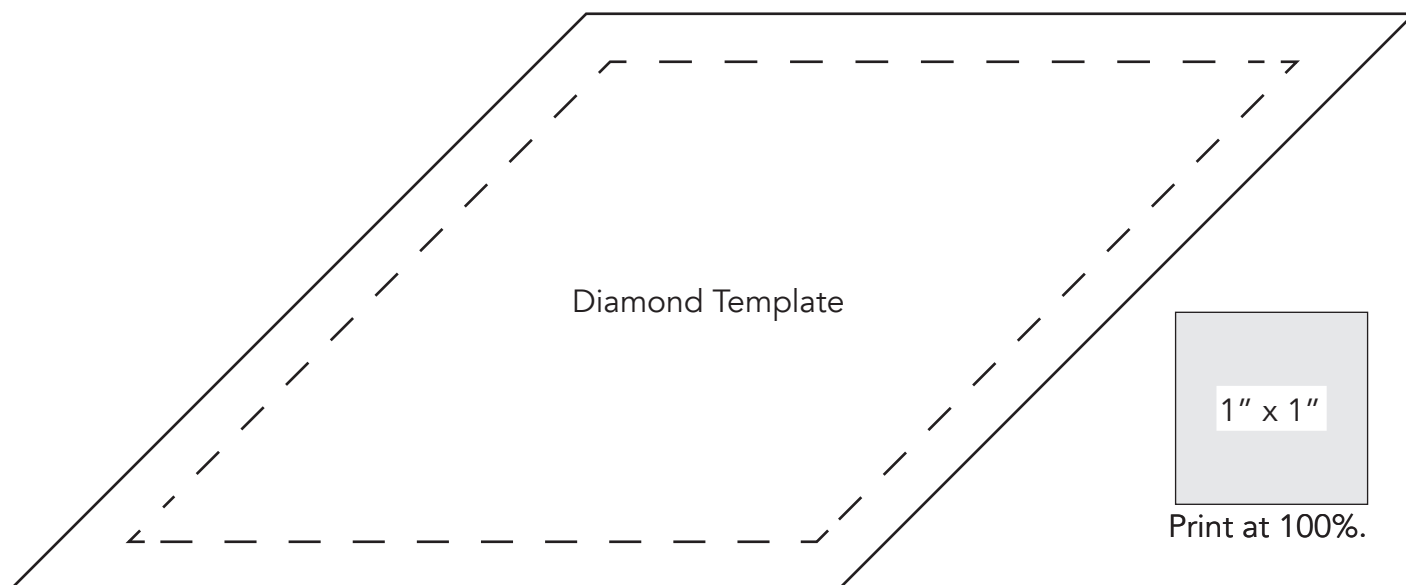



Eliza's Star

QUILT LAYOUT



FINISHING: Layer quilt top, batting and backing together to form quilt sandwich. Baste and quilt as desired. Bind using **H** 2-1/4" strips.